



POWER EQUIPMENT CORPORATION

46-460

MIDI LATHE TYPE 2

WL-24

PART # DPEC001129

DATE: 01-27-12

REVISED: 03-02-16

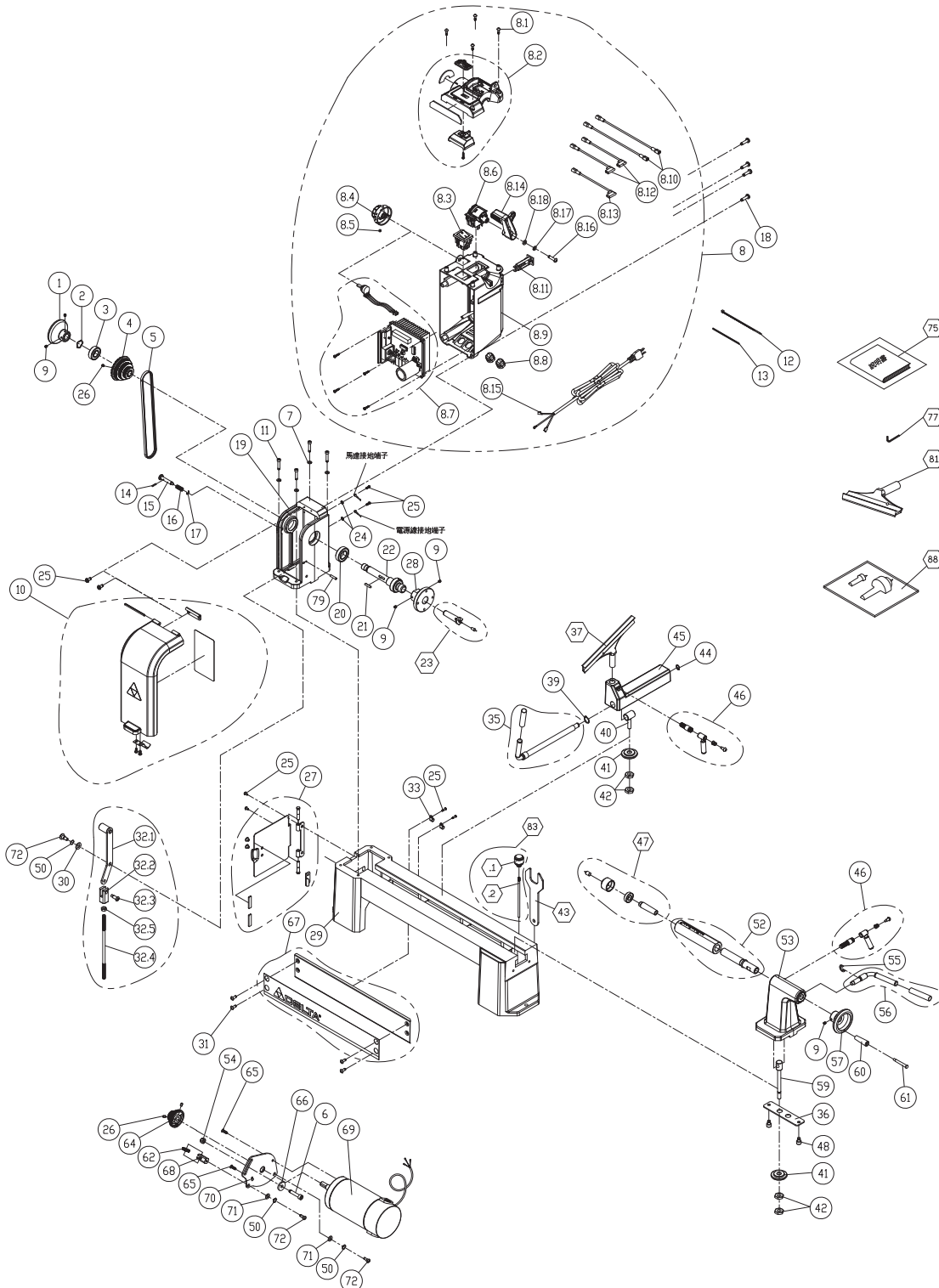

## REPLACEMENT PARTS

NO.	DELTA PART #	DESCRIPTION	QTY	NO.	DELTA PART #	DESCRIPTION	QTY
1	5140059-91	SPINDLE HANDWHEEL	1	13	DPEC000437	PVC PLATE	1
2	5140059-92	WAVY WASHER	1	14	5140059-24	DOWEL PIN	1
3	5140059-93	BALL BEARING	1	15	5140060-39	INDEX PIN	1
4	5140059-06	SPINDLE PULLEY	1	16	5140059-26	SPRING WASHER 24MM	1
5	5140059-94	DRIVE BELT	1	17	5140060-40	E RING ETW-6	1
6	DPEC000461	* CAP SCREW M6 X 1.0P X 30L	1	18	DPEC000436	* RD HD PHILLIPS SCREW M5 X 0.8P X 20L AND WASHER 5.2 ID X 10 OD X 1.0T	4
7	5140059-09	* LOCK WASHER 6.5 ID X 12.8 OD	4	19	5140060-42	HEAD STOCK	1
8	DPEC000212	CONTROLLER BOX	1	20	5140060-43	BALL BEARING #6005	1
8.1	5140059-95	RD HD SELF TAP SCREW M4 X 1.59P X 12L	4	21	5140060-44	KEY	1
8.2	DPEC000468	SWITCH COPVER ASSMBLY	1	22	5140059-31	SPINDLE	1
8.3	DPEC000470	FWD/REV SWITCH	1	23	5140059-89	SPUR CENTER ASSEMBLY	1
8.4	5140059-12	SPD ADJUST KNOB ASSEMBLY	1	24	DPEC000435	* STAR WASHER 5.3 ID X 10 X 0.6T	2
8.5	5140059-13	* NYLOCK SET SCREW M4 X 0.7P X 4L	1	25	5140059-42	* RD HD BOLT M5 X 0.8P X 8L	8
8.6	DPEC000459	ON/OFF SWITCH	1	26	DPEC000434	NYLOCK SET SCREW 1/4"-20NC X 3/8"L	3
8.7	5140059-15	PCB CONTROL ASSY.	1	27	5140060-46	SIDE ACCESS DOOR	1
8.8	5140059-16	STRAIN RELIEF	2	28	5140059-32	FACEPLATE	1
8.9	DPEC000471	CONTROLLER BOX	1	29	5140060-47	BED	1
8.10	5140059-18	CONNECT. WIRE	2	30	5140060-48	* WASHER 8.5 ID X 19 OD X 3T	1
8.11	DPEC000441	OVERLOAD	1	31	5140059-40	* RD HD SOCKET SCREW M5 X 0.8P X 10L	4
8.12	5140059-20	LEAD WIRE	2	32	DPEC000433	LIFT ASSEMBLY	1
8.13	5140059-21	LEAD WIRE	1	.1	5140059-41	BELT ADJUST HANDLE	1
8.14	DPEC000462	SWITCH ACTUATOR	1	.2	5140059-63	BELT ADJUST BRACKET	1
8.15	5140060-37	POWER CORD	1	.3	5140059-73	NYLOCK SHOULDER SCREW M5 X 0.8P X 17.5L	1
8.16	DPEC000463	* RD HD BOLT M5 X 0.8P X 20L	1	.4	5140059-74	BELT ADJUST ROD	1
8.17	DPEC000464	* SPRING WASHER 5.1 ID X 9.3 OD	1	.5	DPEC000431	* HEX NUT M6 X 1.0P	1
8.18	DPEC000465	* FLAT WASHER 5.3 ID X 10 OD X 2T	1	33	DPEC000432	CORD CLAMP	2
9	5140059-22	* NYLOCK SET SCREW 1/4"-20NC X 1/4"L	5	35	5140066-31	LOCK SCREW HANDLE ASSEMBLY	1
10	DPEC000440	DOOR ASSEMBLY	1	36	5140059-87	SLIDE BOARD	1
11	DPEC000439	* NYLOCK CAP SCREW M6 X 1.0P X 30L	4	37	5140059-45	10" TOOL REST	1
12	DPEC000438	BAND	1	39	5140059-83	S RING	1

\* = Item is standard hardware and can be purchased in local hardware or home improvement stores.

## REPLACEMENT PARTS

NO.	DELTA PART #	DESCRIPTION	QTY	NO.	DELTA PART #	DESCRIPTION	QTY
40	5140059-47	ADJUST SHAFT	1	79	5140066-35	DOWEL PIN	1
41	5140059-48	SLIDE COLLAR	2	81	5140059-01	6" TOOL REST	1
42	5140059-82 *	NUT M10 X 1.5P	4	83	5140059-80	ROD ASSEMBLY	1
43	5140060-49	WRENCH 35.2 X 70MM	1	88	DPEC000460	LIVE CENTERS	1
44	5140059-84	S RING	1				
45	5140059-85	TOOL REST BRACKET	1				
46	5140059-51	LOCKING SCREW HANDLE	2				
47	5140059-81	TAILSTOCK CENTER ASSEMBLY	1				
48	5140059-88 *	CAP SCREW M6 X 1.0P X 12L	2				
50	5140059-52	WAVY WASHER WW-8	3				
52	DPEC000430	LEAD SCREW	1				
53	5140059-86	TAILSTOCK	1				
54	DPEC000429 *	NYLOCK NUT M6 X 1.0P (10B X 7H)	1				
55	5140059-55	E RING ETW-12	1				
56	5140066-32	TAIL ECCENTRIC ROD ASSEMBLY	1				
57	5140059-57	TAIL STOCK HANDWHEEL	1				
59	5140059-59	TAIL ADJUST SHAFT	1				
60	5140060-50	HANDLE	1				
61	5140059-61	SHOULDER SCREW 10MM X 56.9MM	1				
62	5140059-62	BELT ADJUST NUT	1				
64	5140059-64	MOTOR PULLEY	1				
65	DPEC000428	SCREW M6	2				
66	5140060-51 *	WASHER 6.4 X 20 X 3T	1				
67	DPEC000427	LABEL SET	1				
68	5140059-68	BELT ADJUST BRACKET	1				
69	5140060-52	MOTOR ASSEMBLY	1				
70	5140060-55	MOTOR BRACKET	1				
71	5140059-71 *	WASHER 8.5 ID X 16 OD X 2T	2				
72	5140060-56 *	NYLOCK SHOULDER SCREW M6 X 1.0P X 20L	3				
75	DPEC000426	MANUAL	1				
77	DPEC000425 *	3MM HEX WRENCH	1				

\* = Item is standard hardware and can be purchased in local hardware or home improvement stores.